

ITEM	PART NO.	QTY	DESCRIPTION
1	AJ-110-32	1	"O" RING, JACK
2	AJ-1100M-14	1	HOUSING, JACK - OM
3	AJ-1100X-2	1	BODY - INSERT, JACK
4	AJ-110PM-1	1	GUIDE

A AJ-1100M

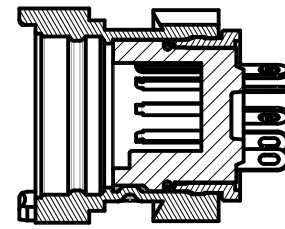
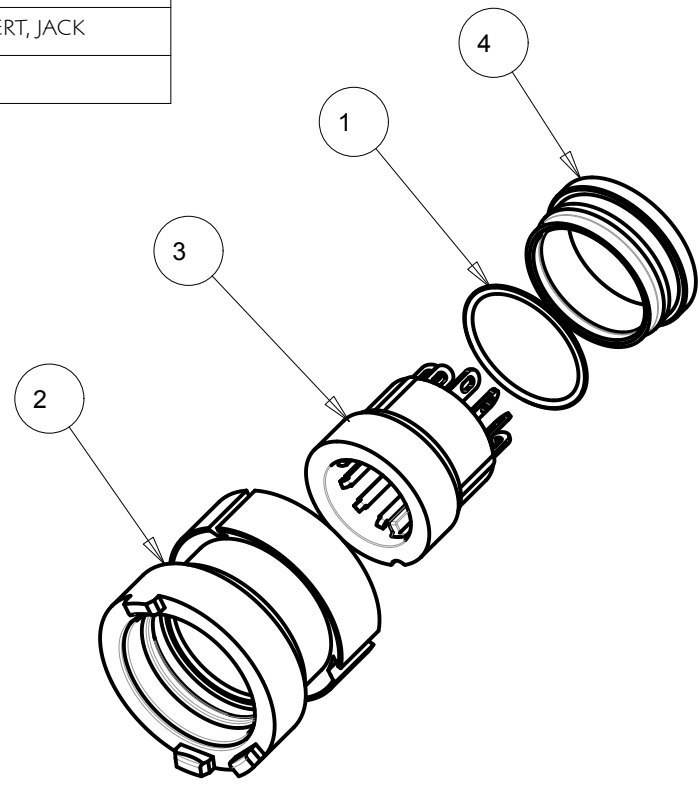

THIS DOCUMENT CONTAINS PROPRIETARY INFORMATION OF NEXUS, INCORPORATED AND SUCH INFORMATION MAY NOT BE DISCLOSED TO OTHERS FOR ANY PURPOSE OR USED FOR ANY PURPOSE WITHOUT THE WRITTEN CONSENT OF NEXUS.

					DWN.BY <b>LDE</b>	DATE 07-Jul-05	MATERIAL
					CHECKED BY	DATE	FINISH
					APPR.BY	DATE	WEIGHT <hr style="width: 50px; border: none; border-bottom: 1px solid black;"/> SCALE = 2.00 :1
					UNLESS OTHERWISE SPECIFIED DIMENSIONS ARE IN INCHES TOLERANCES ON .XX .XXX ANGLES <hr style="width: 50px; border: none; border-bottom: 1px solid black;"/> ±.003 ±.5°		<b>JACK - OM</b>
<b>B</b>	REPLACE AJ-1100M WITH AJ-1100X-2		05/07 2012				
LET.	REVISION	CN #	DATE	CHK.	DO NOT SCALE DWG.		SIZE <b>A</b> DWG. NO. AJ-1100M
					SHEET 1 OF 1		